



RCB quickstart manual

ACE-II-RCB quick guide-v01-e

date : 12-12-2022

Introduction

This document summarize the installation instruction of the ACE residential connection box (RCB).



This instruction manual is addressed to trained staff and requires specific knowledge in dealing with fibre optic, regulations regarding laser radiation and the accident prevention regulations that apply.

A detailed manual with additional application variants you will find by using the QR-code at the right or using the link <https://www.tkf-telecom.eu/en/ace-rcb>



RCB – Standard

The basic configuration of the RCB contains:

1	RCB base	1 pc
2	Splice tray holder incl. adapter holder	1 pc
3	Seal output (9x 0–3mm), divisible	2 pcs
3 ^a	Part 1	
3 ^b	Part 2	
3 ^c	Part 3	
3 ^d	Part 4	
4	Strain relief, plastic (0.9 - 3 mm)	2 pcs
5	Orange splice tray	1 pc
6	Crimp-splice holder for 12 fibers	2 pcs
7	Splice tray cover incl. administration label	1 pc
8	Sealing cover	1 pc
9	RCB cover	1 pc
10	Screw adapter cover	1 pc
11	Safety screw with locking pin M5 x 6	1 pc
12	Strain relief for 10 mm tube, metal	2 pcs
13	Seal input (7-10 mm), divisible	1 pc
13 ^a	bottom part	
13 ^b	top part	
14	Strain relief incl.:	1 pc
14 ^a	bracket, metal	
14 ^b	washer	
14 ^c	screw	
15	Plug (7 mm) for input seal	1 pc
16	Universal plug 6 x 35	3 pcs
17	Screw 4,2 x 38	3 pcs
18	Strain relief for 7 mm tube, metal	2 pcs
19	Cable tie	2 pcs
20	Foam tape	1 pc

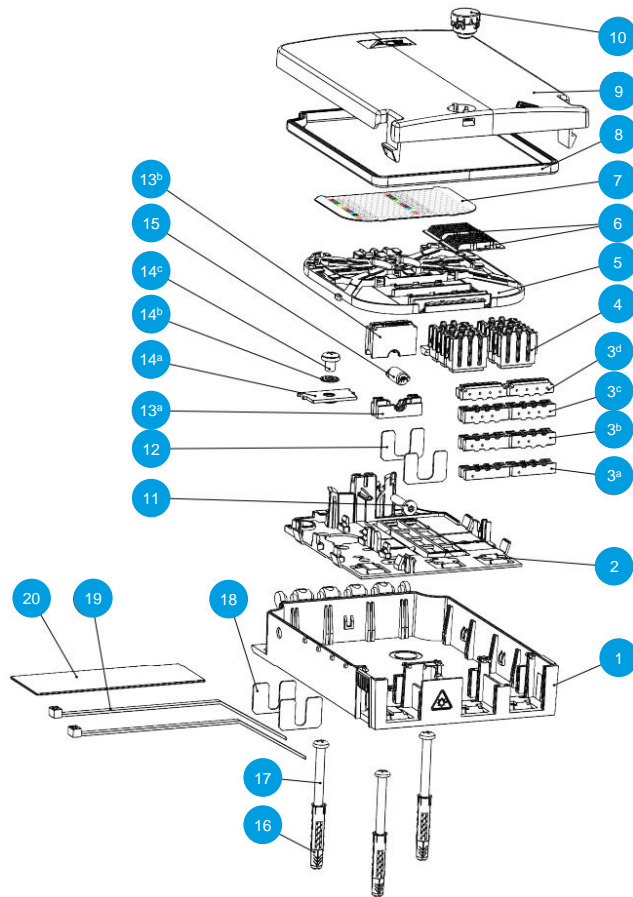

The dimensions of the RCB are 175 x 116 x 50 mm (HxWxD).
Recommended space for box installation is approximately 37 cm x 20 cm (HxW).

Functional overview

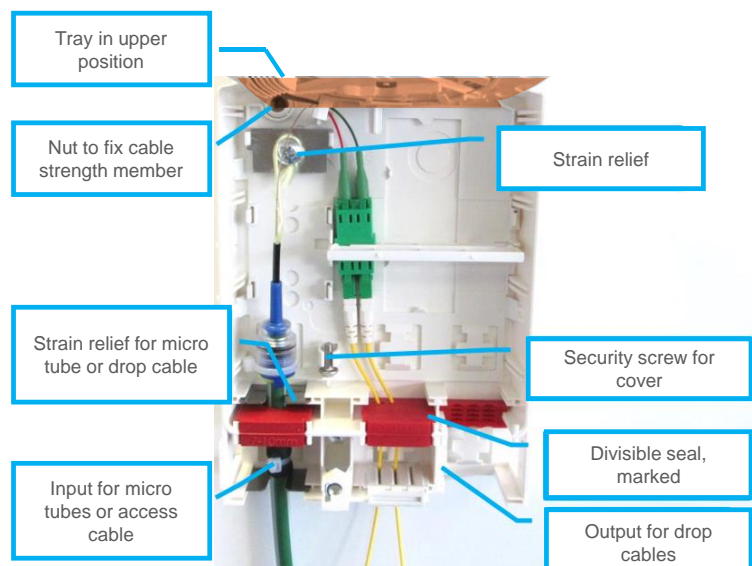



Points of attention

Preparation

Press both locks at the sides of the RCB to open the cover

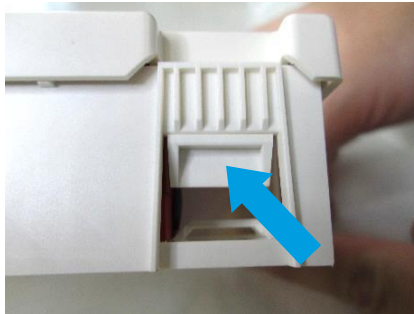

Move the cover relative to the base in order to release the hinge at one side.

Move the opposite side of the cover to separate the cover from the base



Installation

Wall mounting: fix the 3 screws

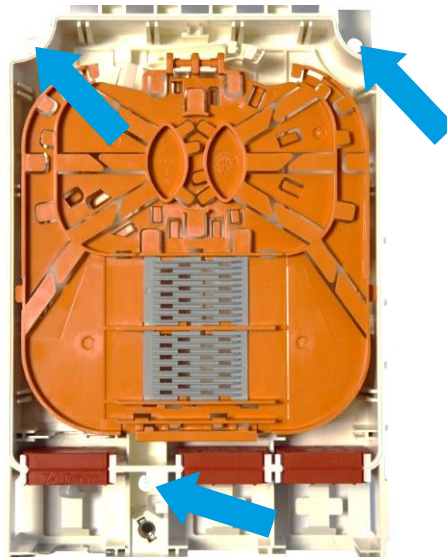



Optionally the wall mounting plate can be applied.
(TKF Art.-no: 566666).

Variant 1

Fix of the mounting plate with all three screws:
Box can be removed from the mounting plate without tooling.

Variant 2

Bottom of the wall mounting plate and the box are both fixed by a screw. The screw is secured after the box is placed inside the mounting plate.

Removing the RCB in this case is only possible when the box is opened.



Assembly

Take patch frame out from the splice tray holder with a side cutter. Make sure that no sharp edges remain at both the splice tray holder and the patch frame.

Push the frame in the correct position. Move it in the right direction until it is fixed.

Push the adapter from the backside to the front (sr. side of the adapter is faced to the front)

Always start at the bottom left position of the patch-frame

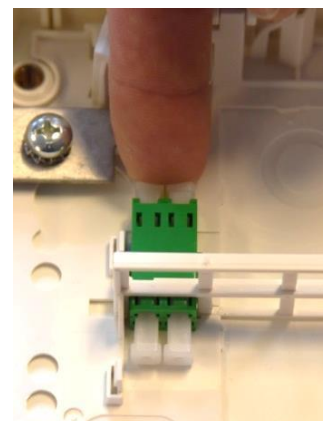
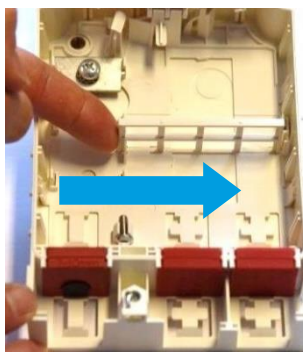

The upper arrow in the picture aside shows the stripping position where the buffer is removed from the fibre.

The lower arrow in the picture aside shows the routing of the pigtails from the adapter to the splice tray.

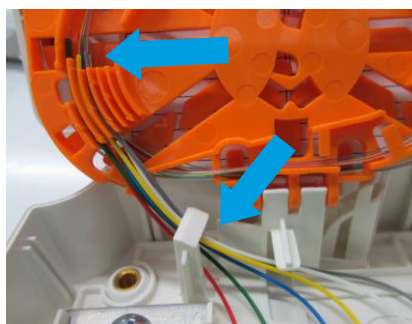

Guide the fibers to the upper side of the cassette.

The fibre lengths can be stored at the upper side of the cassette.

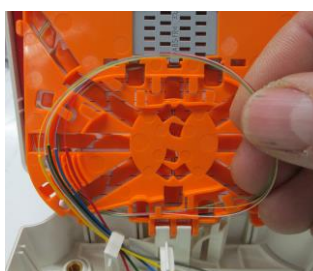

Tube installation

- A Middle position of foam tape around tube
- B Tube ending
- C Strip position cable outer sheath
- D Strip position of fibre buffer (tube)
- E Strain relief aramid yarn
- F

Length of bare fibers:
approximately 160 – 200
cm

Cable installation

- Middle position of foam tape cable sheath
- Middle position of 2nd foam tape cable sheath
- Strip position of cable outer sheath
- Strip position of fibre buffer (tube)
- Strain relief aramid yarn
- Max. length of central strength member

Length of bare fibers:
approximately 160 – 200
cm

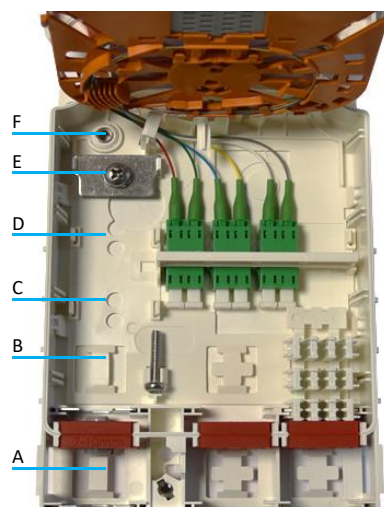

Example of tube – gas-block connector – cable entry in the box.
The gas-block connector seals the cable

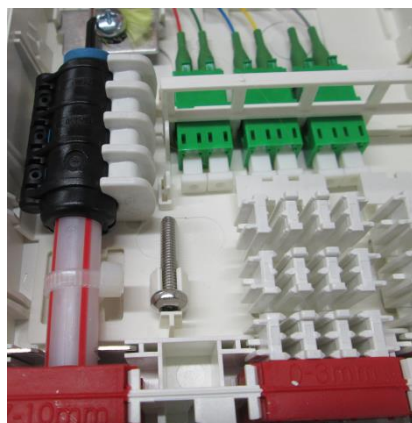

Routing of the feeder fibers

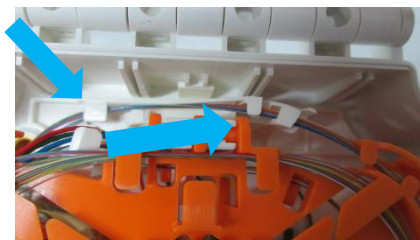

Routing of the spliced fibers.





Example of pigtail seal installation.

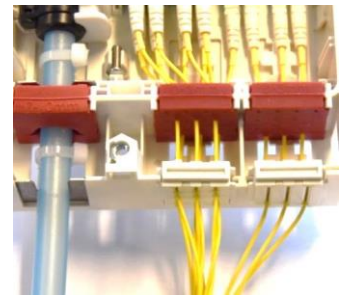

Finishing

Cover the screw lock.

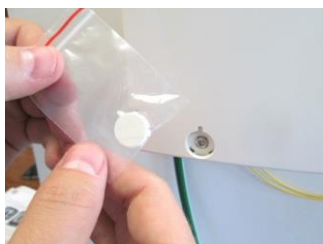

Please contact us for additional configuration features, securing options and further information.

www.tkf-telecom.eu